

M:\WOODLAND\21256- Davidson Ave Water Main\04 Construction\Plan Revisions\DETOUR.dwg, 2/25/2022 12:58 PM, YVONNE PAWTOWSKI

COWLITZ COUNTY  
 FED. AID NO.: XXXX-XXXX(XXX)  
 SECTION 46, T5N, R1W

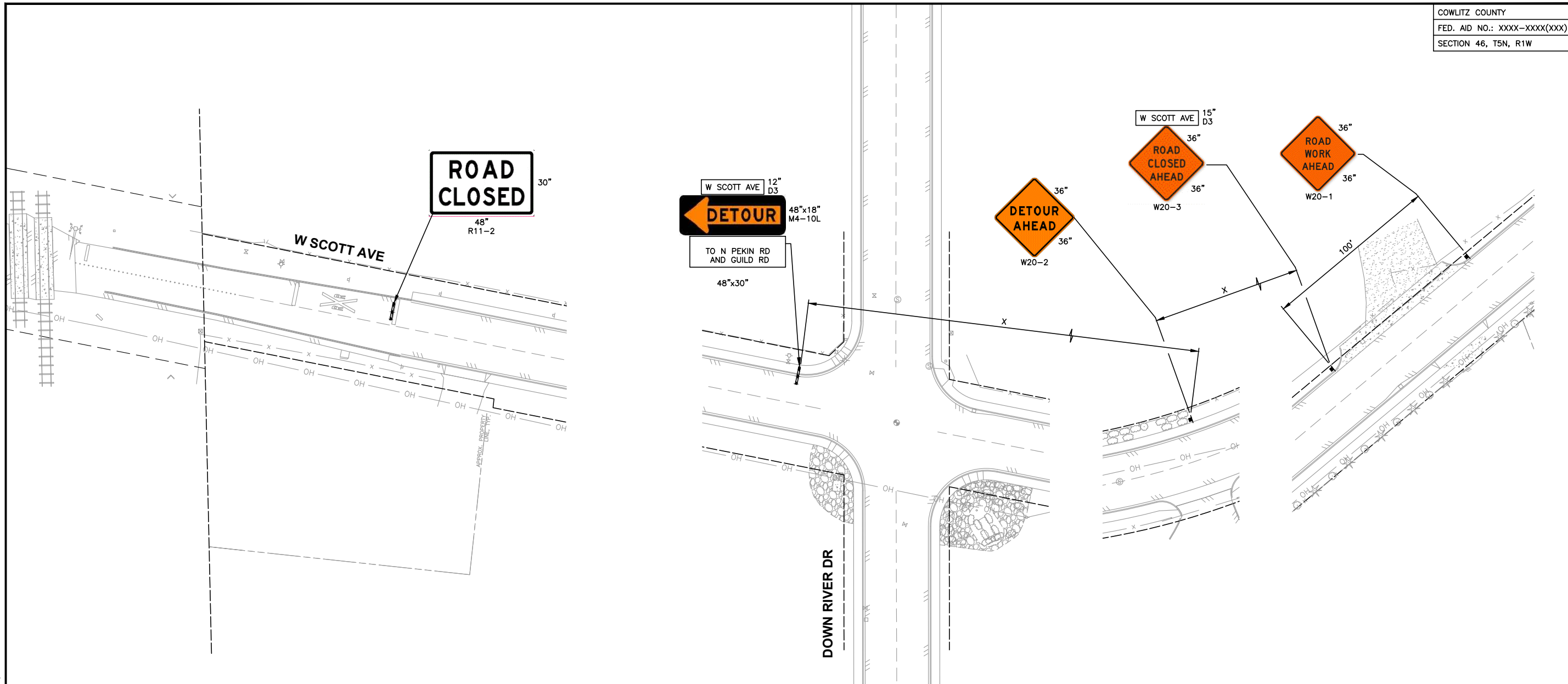

**Gray & Osborne, Inc.**  
 CONSULTING ENGINEERS  
 1130 RAINIER AVENUE SOUTH, SUITE 300  
 SEATTLE, WASHINGTON 98144 • (206) 264-0860

|                 |          |           |     |
|-----------------|----------|-----------|-----|
| DATE: DEC. 2021 | YBP      | TN        | BLS |
| DRAWN:          | CHECKED: | APPROVED: |     |

| No. | REVISION | DATE | APPD. |
|-----|----------|------|-------|
|     |          |      |       |

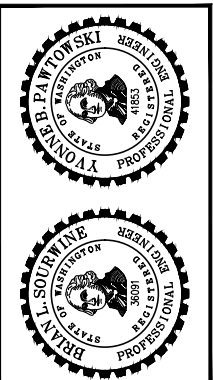

MINIMUM LANE CLOSURE TAPER LENGTH = L (feet)

| LANE WIDTH (feet) | Posted Speed (mph) |     |     |     |     |     |     |     |     |     |
|-------------------|--------------------|-----|-----|-----|-----|-----|-----|-----|-----|-----|
|                   | 25                 | 30  | 35  | 40  | 45  | 50  | 55  | 60  | 65  | 70  |
| 10                | 105                | 150 | 205 | 270 | 450 | 500 | 550 | -   | -   | -   |
| 11                | 115                | 165 | 225 | 295 | 495 | 550 | 605 | 660 | -   | -   |
| 12                | 125                | 180 | 245 | 320 | 540 | 600 | 660 | 720 | 780 | 840 |

SIGN SPACING = X (1)

| ROAD TYPE                        | 55 / 70 MPH    | 1500' +/-    |
|----------------------------------|----------------|--------------|
| FREWAYS & EXPRESSWAYS            | 55 / 70 MPH    | 1500' +/-    |
| RURAL HIGHWAYS                   | 60 / 65 MPH    | 800' +/-     |
| RURAL ROADS                      | 45 / 55 MPH    | 500' +/-     |
| RURAL ROADS & URBAN ARTERIALS    | 35 / 40 MPH    | 350' +/-     |
| RURAL ROADS & URBAN ARTERIALS    | 25 / 30 MPH    | 200' +/- (2) |
| RESIDENTIAL & BUSINESS DISTRICTS |                |              |
| URBAN STREETS                    | 25 MPH OR LESS | 100' +/- (2) |

(1) ALL SPACING MAY BE ADJUSTED TO ACCOMMODATE INTERCHANGE RAMP, AT-GRADE INTERSECTIONS AND DRIVEWAYS.  
 (2) THIS SPACING MAY BE REDUCED IN URBAN AREAS TO FIT ROADWAY CONDITIONS.

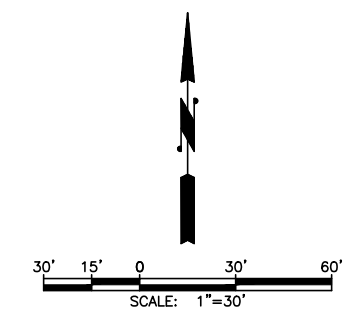

**LEGEND**

|  |                                     |
|--|-------------------------------------|
|  | BARRICADE - TYPE 3 WITH R11-2 (B/W) |
|  | BARRICADE - TYPE 2                  |
|  | SIGN LOCATION                       |

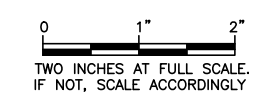

CITY OF WOODLAND  
 COWLITZ COUNTY WASHINGTON  
 W SCOTT AVE PEDESTRIAN PAVEMENT AND SIDEWALK IMPROVEMENTS  
 DETOUR PLAN

DRAWING: TC-3  
 SHEET: 19 OF 18  
 JOB NO.: 19624.04  
 DWG:DETOUR