

Property Owned by the City

How much property does the city own?

The City of Woodland has a large amount of property in the form of street right-of-way but generally speaking, the city has ownership of about 95.79 acres of property. Of that, 3.15 acres are in Clark County, with the remaining 92.6 acres in Cowlitz County.

Note: This does not include any of the right-of-way for Interstate 5 or State Route 503. That land belongs to either the State of US Department of Transportation. It also does not include any surface water like Horseshoe Lake or the Lewis River.

How many acres of park property does the city have?

The City of Woodland owns:

- Horseshoe Lake Park (6.5 acres)
- Hoffman Park (1.17 acre)
- Kenneth Bjur Memorial Park (.2 acre)
- Eagle Park (.3 acre)
- Horseshoe Lake Park Extension (.2 acres) (Clark County)
- Goerig Park (.4 acres) (Clark County)
- Scott Hill Park (46.7 acres)
- Civic Center property (.48 acres)

The city owns 6.19 acres of open space near the Lewis River but this property is within the floodway of the river and there are limitations on what can be done with the property.

Does the city own any properties with buildings or facilities on them?

Yes. In addition to Horseshoe Lake Park which has several shelters and buildings on it, the city owns/operates:

- City Hall & Public Works Office (.16 acres)
- Police Station (2.4 acres)
- Fire Station property (3.28 acres)
- 100 Davidson (Old City Hall/Fire Station) (.43 acres)
- The Public Works maintenance shops (2.55 acres in Clark County)
- Downtown parking lots (.35 acres)
- The Community Center & Library (.71 acre of Hoffman Park)
- The city well (.48 acres)
- The Wastewater Treatment Plant (3.83 acres)
- The Water Treatment Plant (8.5 acres)
- The city owns several open space/wetland/stormwater tracts (9.78 acres)



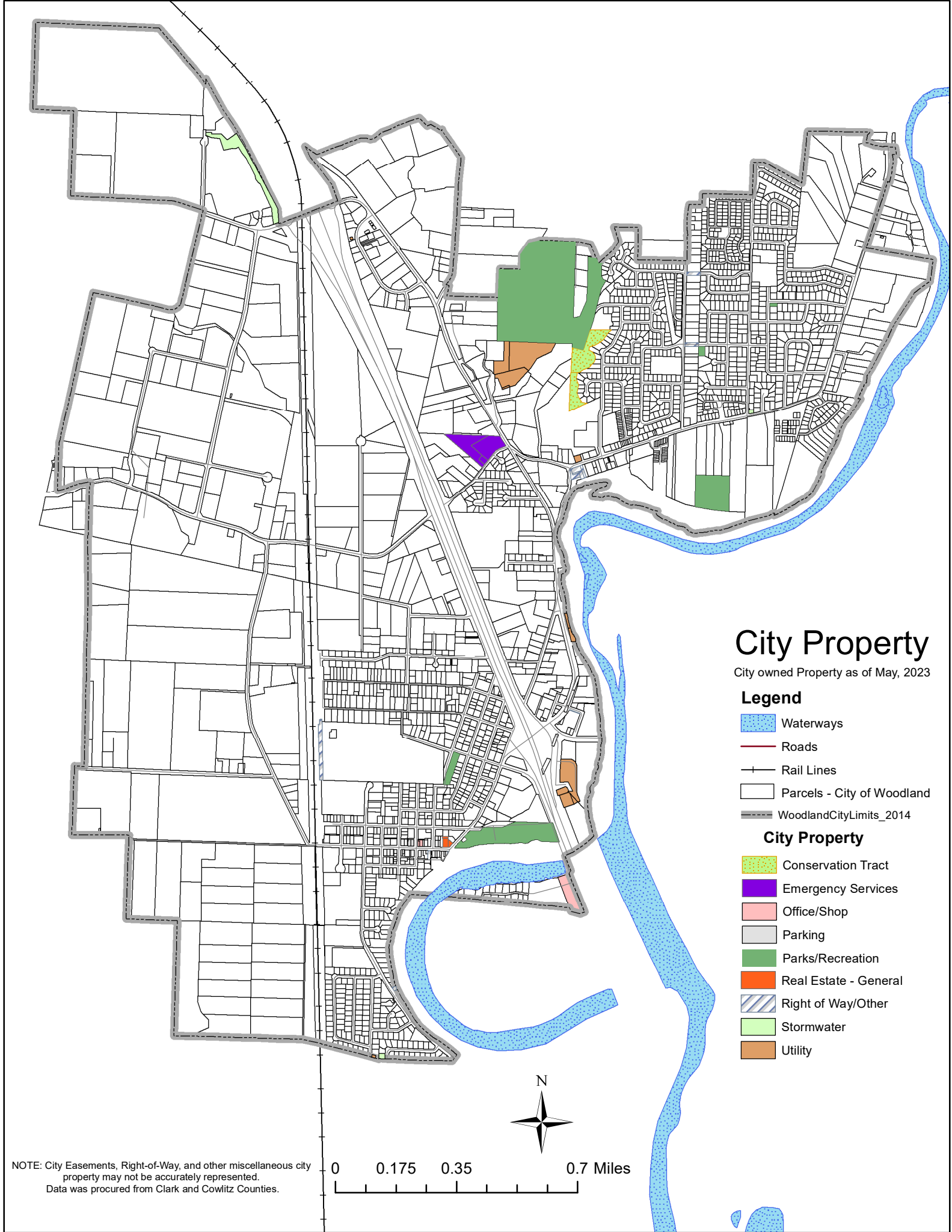

This city also owns a large amount of right-of-way but the total acreage of our street system is not available.



City Property

City owned Property as of May, 2023

Legend

-  Waterways
-  Roads
-  Rail Lines
-  Parcels - City of Woodland
-  WoodlandCityLimits_2014

City Property

-  Conservation Tract
-  Emergency Services
-  Office/Shop
-  Parking
-  Parks/Recreation
-  Real Estate - General
-  Right of Way/Other
-  Stormwater
-  Utility



NOTE: City Easements, Right-of-Way, and other miscellaneous city property may not be accurately represented.
Data was procured from Clark and Cowlitz Counties.

