

EXISTING CONDITIONS SURVEY

LOT 1 OF "EUGENE BLETH SHORT PLAT" (12-148) AND A PORTION OF THE SOLOMON STRONG DLC NO. 46, LOCATED IN THE SE 1/4 OF SECTION 14, T. 5 N., R. 1 W., W.M. CITY OF WOODLAND, COWLITZ COUNTY, WASHINGTON

LEGEND:

- INDICATES FOUND MONUMENT
- INDICATES WATER VALVE
- INDICATES FIRE HYDRANT
- INDICATES STORM SEWER MANHOLE
- INDICATES DITCH INLET
- INDICATES CATCH BASIN
- INDICATES SANITARY SEWER MANHOLE
- INDICATES SANITARY LATERAL
- INDICATES TRANSFORMER
- INDICATES GAS MARKER
- INDICATES BOLLARD
- INDICATES UNIDENTIFIED CLEANOUT
- INDICATES DECIDUOUS TREE WITH TRUNK DIAMETER
- INDICATES BOUNDARY
- INDICATES EDGE OF ASPHALT
- INDICATES EDGE OF CONCRETE
- INDICATES EDGE OF GRAVEL
- INDICATES 5 FOOT INTERVAL CONTOUR
- INDICATES 1 FOOT INTERVAL CONTOUR
- INDICATES FENCE LINE
- INDICATES SANITARY LOCATE
- INDICATES STORM LOCATE

BENCH MARK:
 OPUS PT. MGS CP #50
 LARGE MAGAL WITH WASHER STAMPED "MGS CONTROL"
 ON EAST SIDE OF HOWARD WAY
 ELEVATION = 18.80' NAVD 88 DATUM

HORIZONTAL DATUM AND BASIS OF BEARING:
 NAD83_2011(EPOCH:2010.0000) WASHINGTON STATE PLANE COORDINATE SYSTEM
 SOUTH ZONE, US-FEET

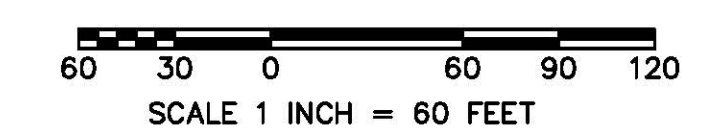
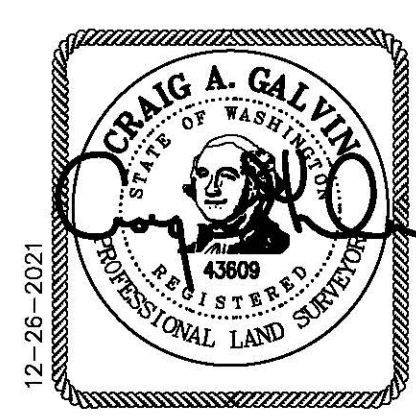

MINISTER-GLAESER SURVEYING INC.
 2200 E. EVERGREEN BLVD.
 VANCOUVER, WA 98661
 (360) 694-3313

SCALE: 1"=60'
 JOB NO. 21-496
 DATE: 12-26-21
 CALC BY: CAG
 DRAWN BY: CAG
 CHECKED BY: DAR
 SHEET 1 OF 1

