

# SCOTT HILL PARK & SPORTS COMPLEX

SECTION 13 TOWNSHIP 5 NORTH, RANGE 01 WEST, W.M.  
"WOODLAND", WASHINGTON

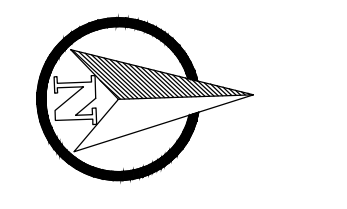

SCALE: 1"=100 FEET  
0 50 100 200

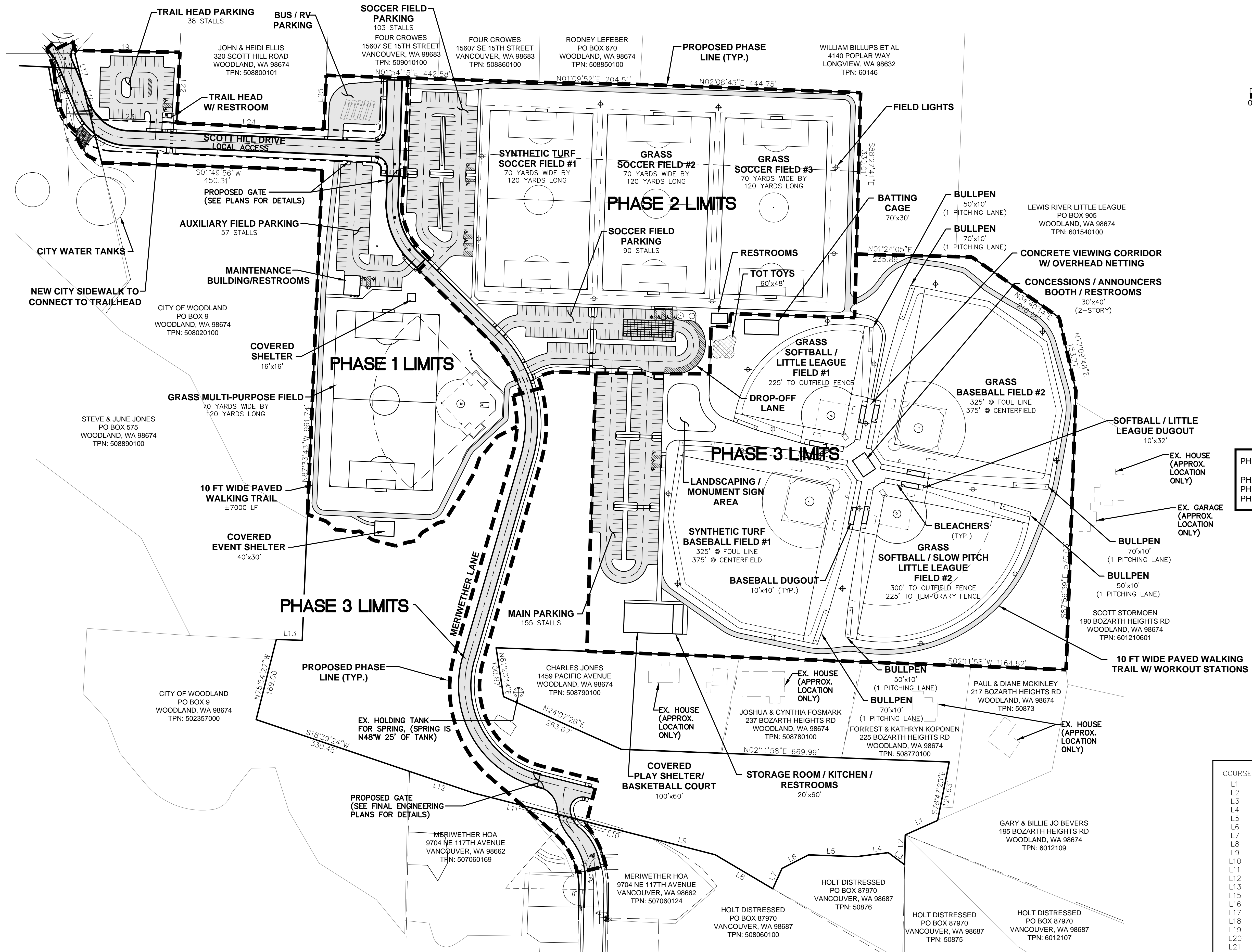
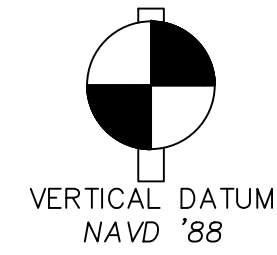

**PHASING SCHEDULE**

|         |             |
|---------|-------------|
| PHASE 1 | 2017 - 2023 |
| PHASE 2 | 2023 - 2025 |
| PHASE 3 | 2026 - 2028 |

| COURSE | BEARING       | DISTANCE |
|--------|---------------|----------|
| L1     | S 24°06'31" E | 72.54'   |
| L2     | S 88°47'51" E | 60.88'   |
| L3     | S 36°26'55" W | 41.46'   |
| L4     | S 07°11'20" E | 65.67'   |
| L5     | S 02°07'54" W | 97.67'   |
| L6     | S 27°07'34" E | 61.00'   |
| L7     | S 65°37'23" E | 45.54'   |
| L8     | S 30°37'04" W | 136.52'  |
| L9     | S 14°26'00" W | 134.41'  |
| L10    | S 14°17'33" W | 205.50'  |
| L11    | S 14°17'33" W | 167.71'  |
| L12    | S 18°39'23" W | 139.87'  |
| L13    | N 02°11'58" E | 52.84'   |
| L14    | S 76°08'10" W | 91.79'   |
| L15    | S 76°08'10" W | 105.25'  |
| L16    | S 76°08'10" W | 32.89'   |
| L17    | N 48°27'37" W | 8.67'    |
| L18    | N 01°02'07" E | 208.77'  |
| L19    | N 87°28'55" W | 131.73'  |
| L20    | N 19°37'29" E | 66.88'   |
| L21    | S 87°28'55" E | 144.65'  |
| L22    | N 02°30'43" E | 175.20'  |
| L23    | N 02°30'43" E | 300.85'  |
| L24    | N 87°33'43" W | 110.85'  |
| L25    | N 87°33'43" W | 110.85'  |

| NO. | DATE | REVISION |
|-----|------|----------|
|     |      |          |
|     |      |          |

DESIGNED BY: RMB  
DRAWN BY: NJG/BJR  
CHECKED BY: RMB  
DATE: 2-16-22  
SCALE: 1" = 100'

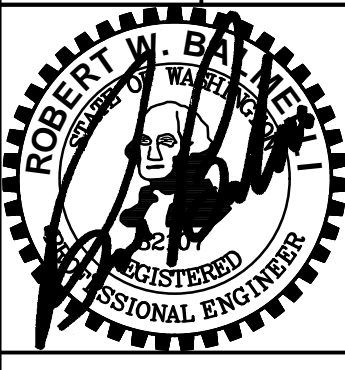

OVERALL COMPOSITE SITE PLAN



**RB Engineering**  
DESIGN - PERMIT - MANAGE  
OFF: (509) 740-8819  
EMAIL: info@rbengineering.com  
P.O. Box 323  
Oreanus, WA 98532

**811** Know what's below. Call 811 before you dig.  
JOB NUMBER: 15001  
DRAWING NAME: 15001\_C3.1\_STPL  
**C3.1**  
5 OF 29