

Planting Schedule

Symbol	Common name / Botanical name	Planting size	Mature size
○	Edith bogue magnolia / Magnolia grandiflora	2" cal	25' x 20'
○	Paperbark Maple / Acer griseum	2" cal	25' x 20'
○	Persian Parrotia / Parrotia persica	2" cal	30' x 20'
○	Capital Pear / Pyrus calleryana	2" cal	30' x 15'
○	Mt. Fire Pines / Pinus japonica "Mt Fire"	1 gal	3' x 3'
○	Nandina / Nandina domestica "Gulf Stream"	1 gal	3' x 3'
○	Bird Nest Spruce / Picea abies "Nidiformis"	1 gal	3' x 3'
○	Jean Marie Rhododendron / Rhododendron	1 gal	4' x 4'
○	Pachysandra / Pachysandra procumbens	4" container or	
○	Kimilinnick / Antostaphylos uva-ursi	4" container	
L	Lawn		

Landscape & Lighting Notes

1. All plants and shrubs are contained on this Plan to avoid conflicts.
2. Any existing vegetation that interferes with proposed landscaping shall be removed.
3. 'C' indicates typical light pole.
4. 'X' indicates typical light fixture attached to building.
5. 'X' indicates street light.
6. Landscaping for each building will be irrigated by underground irrigation systems.

Preliminary Utility Plan Notes

1. This Preliminary Utility Plan indicates the existing water line and sewer line along Franklin Street and the proposed water and sewer lines in the proposed southerly extension of Franklin Street. A 6" sewer lateral and a water service will be connected to each building.
2. On-site stormwater will be drained to the treatment and detention swales adjacent to the edge of the parking areas. The swales will connect to the water service facility and be conveyed to the existing stormwater facility in adjacent Pacific Park Center.

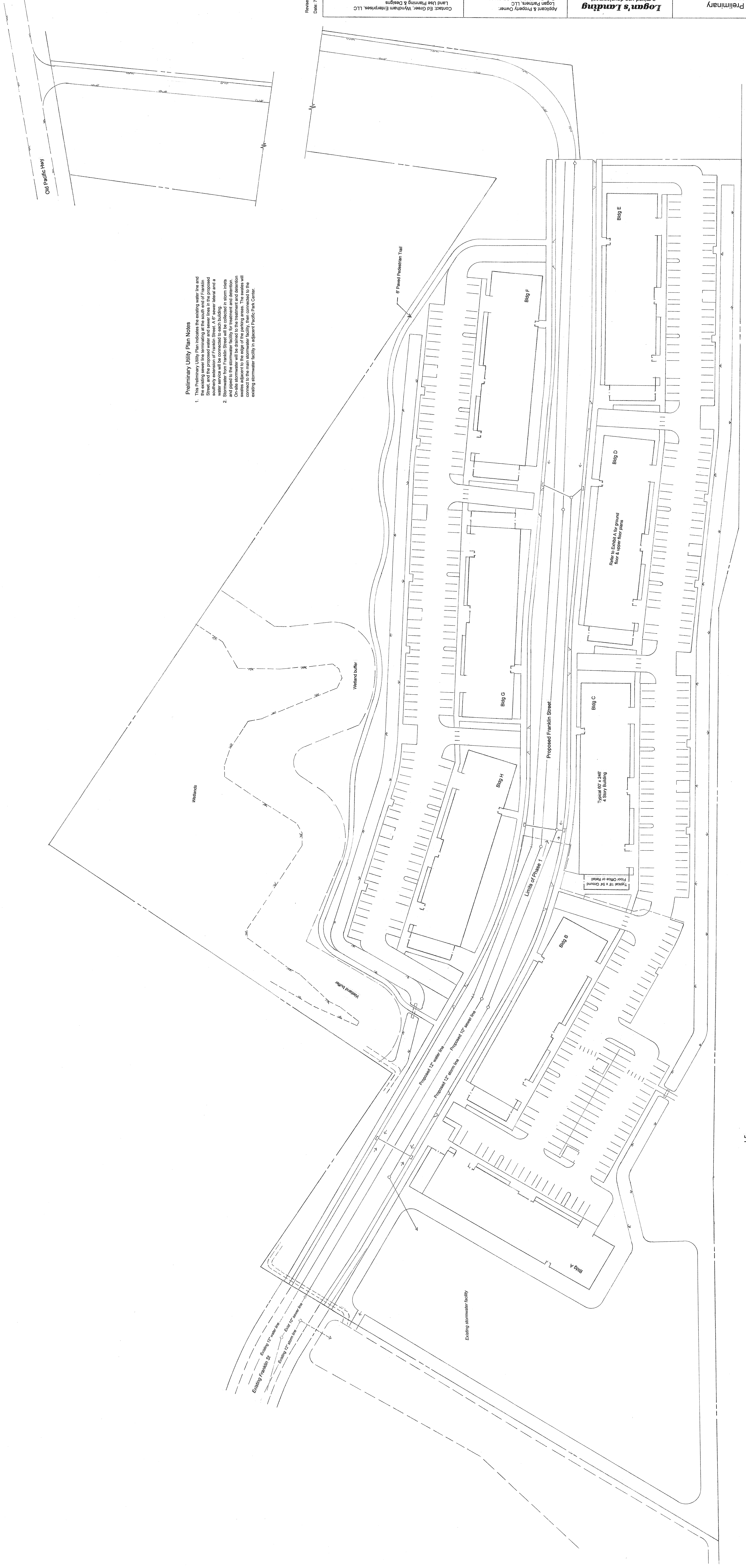

Old Pacific Hwy

Wetlands

Wetland buffer

6" Paved Pedestrian Trail

Bldg G

Bldg H

Limit of Phase 1

Proposed Franklin Street

Bldg C

Bldg D

Bldg E

Typical 60' x 240'
4 Story Building

Typical 18' x 54' Ground
Floor Office or Retail

Refer to Exhibit A for ground
floor & upper floor plans

Bldg B

Bldg A

Existing stormwater facility

Existing Franklin St

Existing 12" water line

Existing 12" sewer line

Proposed 12" water line

Proposed 12" sewer line

Proposed 10" stormwater line