

ELEVATION CERTIFICATE

Important: Follow the instructions on pages 1-9.

Copy all pages of this Elevation Certificate and all attachments for (1) community official, (2) insurance agent/company, and (3) building owner.

SECTION A – PROPERTY INFORMATION						FOR INSURANCE COMPANY USE
A1. Building Owner's Name LGI Homes					Policy Number:	
A2. Building Street Address (including Apt., Unit, Suite, and/or Bldg. No.) or P.O. Route and Box No. 402 Gorge Ct.					Company NAIC Number:	
City Woodland		State Washington		ZIP Code 98674		
A3. Property Description (Lot and Block Numbers, Tax Parcel Number, Legal Description, etc.) Lot 6, Meriwether Hilltop PH. 1, Ph. 1B (Vol. 14, Pg. 118)						
A4. Building Use (e.g., Residential, Non-Residential, Addition, Accessory, etc.) <u>Residential</u>						
A5. Latitude/Longitude: Lat. <u>45°55'33.68"</u> Long. <u>-122°44'14.25"</u> Horizontal Datum: <input type="checkbox"/> NAD 1927 <input checked="" type="checkbox"/> NAD 1983						
A6. Attach at least 2 photographs of the building if the Certificate is being used to obtain flood insurance.						
A7. Building Diagram Number <u>9</u>						
A8. For a building with a crawlspace or enclosure(s):						
a) Square footage of crawlspace or enclosure(s) <u>1,124</u> sq ft						
b) Number of permanent flood openings in the crawlspace or enclosure(s) within 1.0 foot above adjacent grade <u>15</u>						
c) Total net area of flood openings in A8.b <u>1,155</u> sq in						
d) Engineered flood openings? <input type="checkbox"/> Yes <input checked="" type="checkbox"/> No						
A9. For a building with an attached garage:						
a) Square footage of attached garage <u>400</u> sq ft						
b) Number of permanent flood openings in the attached garage within 1.0 foot above adjacent grade <u>0</u>						
c) Total net area of flood openings in A9.b <u>0</u> sq in						
d) Engineered flood openings? <input type="checkbox"/> Yes <input checked="" type="checkbox"/> No						
SECTION B – FLOOD INSURANCE RATE MAP (FIRM) INFORMATION						
B1. NFIP Community Name & Community Number City of Woodland 530035				B2. County Name Cowlitz		B3. State Washington
B4. Map/Panel Number 53015C0886	B5. Suffix G	B6. FIRM Index Date 12/15/2016	B7. FIRM Panel Effective/ Revised Date 12/15/2016	B8. Flood Zone(s) AE	B9. Base Flood Elevation(s) (Zone AO, use Base Flood Depth) 37.3'	
B10. Indicate the source of the Base Flood Elevation (BFE) data or base flood depth entered in Item B9: <input checked="" type="checkbox"/> FIS Profile <input type="checkbox"/> FIRM <input type="checkbox"/> Community Determined <input type="checkbox"/> Other/Source: _____						
B11. Indicate elevation datum used for BFE in Item B9: <input type="checkbox"/> NGVD 1929 <input checked="" type="checkbox"/> NAVD 1988 <input type="checkbox"/> Other/Source: _____						
B12. Is the building located in a Coastal Barrier Resources System (CBRS) area or Otherwise Protected Area (OPA)? <input type="checkbox"/> Yes <input checked="" type="checkbox"/> No Designation Date: _____ <input type="checkbox"/> CBRS <input type="checkbox"/> OPA						

ELEVATION CERTIFICATE

OMB No. 1660-0008
Expiration Date: November 30, 2018

IMPORTANT: In these spaces, copy the corresponding information from Section A.			FOR INSURANCE COMPANY USE
Building Street Address (including Apt., Unit, Suite, and/or Bldg. No.) or P.O. Route and Box No. 402 Gorge Ct.			Policy Number:
City Woodland	State Washington	ZIP Code 98674	Company NAIC Number

SECTION C – BUILDING ELEVATION INFORMATION (SURVEY REQUIRED)

C1. Building elevations are based on: Construction Drawings* Building Under Construction* Finished Construction

*A new Elevation Certificate will be required when construction of the building is complete.

C2. Elevations – Zones A1–A30, AE, AH, A (with BFE), VE, V1–V30, V (with BFE), AR, AR/A, AR/AE, AR/A1–A30, AR/AH, AR/AO. Complete Items C2.a–h below according to the building diagram specified in Item A7. In Puerto Rico only, enter meters.

Benchmark Utilized: WSDOT/NOAA Vertical Datum: NAVD 1988

Indicate elevation datum used for the elevations in items a) through h) below.

NGVD 1929 NAVD 1988 Other/Source: _____

Datum used for building elevations must be the same as that used for the BFE.

Check the measurement used.

- a) Top of bottom floor (including basement, crawlspace, or enclosure floor) 37.5 feet meters
- b) Top of the next higher floor 41.2 feet meters
- c) Bottom of the lowest horizontal structural member (V Zones only) N/A feet meters
- d) Attached garage (top of slab) 39.4 feet meters
- e) Lowest elevation of machinery or equipment servicing the building (Describe type of equipment and location in Comments) 40.9 feet meters
- f) Lowest adjacent (finished) grade next to building (LAG) 39.4 feet meters
- g) Highest adjacent (finished) grade next to building (HAG) 39.8 feet meters
- h) Lowest adjacent grade at lowest elevation of deck or stairs, including structural support 40.0 feet meters

SECTION D – SURVEYOR, ENGINEER, OR ARCHITECT CERTIFICATION

This certification is to be signed and sealed by a land surveyor, engineer, or architect authorized by law to certify elevation information. I certify that the information on this Certificate represents my best efforts to interpret the data available. I understand that any false statement may be punishable by fine or imprisonment under 18 U.S. Code, Section 1001.

Were latitude and longitude in Section A provided by a licensed land surveyor? Yes No Check here if attachments.

Certifier's Name License Number
Howard S. Richardson 38485

Title
PLS

Company Name
Olson Engineering, Inc.

Address
222 E. Evergreen Blvd.

City State ZIP Code
Vancouver Washington 98660

Signature Date Telephone
[Signature] 4-11-18 (360) 695-1385

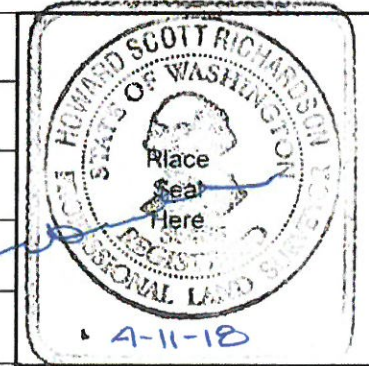

Copy all pages of this Elevation Certificate and all attachments for (1) community official, (2) insurance agent/company, and (3) building owner.

Comments (including type of equipment and location, per C2(e), if applicable)

A5 was taken from GoogleEarth and field verified. C2-elevations were established from bench marks set by fast static GPS observations on WSDOT and NOAA benchmarks and balanced using OPUS. C2e is to the bottom of the water heater in the garage. C2h is the bottom of the roof support pier on the east side of the structure.

ELEVATION CERTIFICATE

OMB No. 1660-0008
Expiration Date: November 30, 2018

IMPORTANT: In these spaces, copy the corresponding information from Section A.			FOR INSURANCE COMPANY USE
Building Street Address (including Apt., Unit, Suite, and/or Bldg. No.) or P.O. Route and Box No. 402 Gorge Ct.			Policy Number:
City Woodland	State Washington	ZIP Code 98674	Company NAIC Number

SECTION E – BUILDING ELEVATION INFORMATION (SURVEY NOT REQUIRED) FOR ZONE AO AND ZONE A (WITHOUT BFE)

For Zones AO and A (without BFE), complete Items E1–E5. If the Certificate is intended to support a LOMA or LOMR-F request, complete Sections A, B, and C. For Items E1–E4, use natural grade, if available. Check the measurement used. In Puerto Rico only, enter meters.

- E1. Provide elevation information for the following and check the appropriate boxes to show whether the elevation is above or below the highest adjacent grade (HAG) and the lowest adjacent grade (LAG).
- a) Top of bottom floor (including basement, crawlspace, or enclosure) is _____ feet meters above or below the HAG.
- b) Top of bottom floor (including basement, crawlspace, or enclosure) is _____ feet meters above or below the LAG.
- E2. For Building Diagrams 6–9 with permanent flood openings provided in Section A Items 8 and/or 9 (see pages 1–2 of Instructions), the next higher floor (elevation C2.b in the diagrams) of the building is _____ feet meters above or below the HAG.
- E3. Attached garage (top of slab) is _____ feet meters above or below the HAG.
- E4. Top of platform of machinery and/or equipment servicing the building is _____ feet meters above or below the HAG.
- E5. Zone AO only: If no flood depth number is available, is the top of the bottom floor elevated in accordance with the community's floodplain management ordinance? Yes No Unknown. The local official must certify this information in Section G.

SECTION F – PROPERTY OWNER (OR OWNER'S REPRESENTATIVE) CERTIFICATION

The property owner or owner's authorized representative who completes Sections A, B, and E for Zone A (without a FEMA-issued or community-issued BFE) or Zone AO must sign here. The statements in Sections A, B, and E are correct to the best of my knowledge.

Property Owner or Owner's Authorized Representative's Name			
Address	City	State	ZIP Code
Signature	Date	Telephone	

Comments

Check here if attachments.

ELEVATION CERTIFICATE

BUILDING PHOTOGRAPHS

See Instructions for Item A6.

OMB No. 1660-0008
Expiration Date: November 30, 2018

IMPORTANT: In these spaces, copy the corresponding information from Section A.			FOR INSURANCE COMPANY USE
Building Street Address (including Apt., Unit, Suite, and/or Bldg. No.) or P.O. Route and Box No. 402 Gorge Ct.			Policy Number:
City Woodland	State Washington	ZIP Code 98674	Company NAIC Number

If using the Elevation Certificate to obtain NFIP flood insurance, affix at least 2 building photographs below according to the instructions for Item A6. Identify all photographs with date taken; "Front View" and "Rear View"; and, if required, "Right Side View" and "Left Side View." When applicable, photographs must show the foundation with representative examples of the flood openings or vents, as indicated in Section A8. If submitting more photographs than will fit on this page, use the Continuation Page.



Photo One

Photo One Caption Front (west) view 04/11/18



Photo Two

Photo Two Caption :Rear (east) view 04/11/18

DEPARTMENT OF HOMELAND SECURITY - FEDERAL EMERGENCY MANAGEMENT AGENCY
COMMUNITY ACKNOWLEDGMENT FORM

O.M.B. NO. 1660-0015
 Expires February 28, 2014

PAPERWORK BURDEN DISCLOSURE NOTICE

Public reporting burden for this data collection is estimated to average 1.38 hours per response. The burden estimate includes the time for reviewing instructions, searching existing data sources, gathering and maintaining the needed data, and completing and submitting the form. This collection is required to obtain or retain benefits. You are not required to respond to this collection of information unless a valid OMB control number is displayed on this form. Send comments regarding the accuracy of the burden estimate and any suggestions for reducing this burden to: Information Collections Management, Department of Homeland Security, Federal Emergency Management Agency, 1800 South Bell Street, Arlington, VA 20598-3005, Paperwork Reduction Project (1660-0015). NOTE: Do not send your completed form to this address.

This form must be completed for requests involving the existing or proposed placement of fill (complete Section A) *OR* to provide acknowledgment of this request to remove a property from the SFHA which was previously located within the regulatory floodway (complete Section B).

This form must be completed and signed by the official responsible for floodplain management in the community. The six digit NFIP community number and the subject property address must appear in the spaces provided below. Incomplete submissions will result in processing delays. Please refer to the MT-1 instructions for additional information about this form.

Community Number: 530035

Property Name or Address: Lot 6, Meriwether Meriwether Hilltop 1B (Vol.14, Pg.118)
 402 Gorge Ct. Woodland WA 98674

A. REQUESTS INVOLVING THE PLACEMENT OF FILL

As the community official responsible for floodplain management, I hereby acknowledge that we have received and reviewed this Letter of Map Revision Based on Fill (LOMR-F) or Conditional LOMR-F request. Based upon the community's review, we find the completed or proposed project meets or is designed to meet all of the community floodplain management requirements, including the requirement that no fill be placed in the regulatory floodway, and that all necessary Federal, State, and local permits have been, or in the case of a Conditional LOMR-F, will be obtained. For Conditional LOMR-F requests, the applicant has or will document Endangered Species Act (ESA) compliance to FEMA prior to issuance of the Conditional LOMR-F determination. For LOMR-F requests, I acknowledge that compliance with Sections 9 and 10 of the ESA has been achieved independently of FEMA's process. Section 9 of the ESA prohibits anyone from "taking" or harming an endangered species. If an action might harm an endangered species, a permit is required from U.S. Fish and Wildlife Service or National Marine Fisheries Service under Section 10 of the ESA. For actions authorized, funded, or being carried out by Federal or State agencies, documentation from the agency showing its compliance with Section 7(a)(2) of the ESA will be submitted. In addition, we have determined that the land and any existing or proposed structures to be removed from the SFHA are or will be reasonably safe from flooding as defined in 44CFR 65.2(c), and that we have available upon request by DHS-FEMA, all analyses and documentation used to make this determination. For LOMR-F requests, we understand that this request is being forwarded to DHS-FEMA for a possible map revision.

Community Comments:

Community Official's Name and Title: (Please Print or Type)

Travis Goodbird Comm. Dev Director

Telephone No.:

360-225-7299

Community Name:

City of Woodland 530035

Community Official's Signature: (required)

Travis Goodbird

Date:

4/20/18

B. PROPERTY LOCATED WITHIN THE REGULATORY FLOODWAY

As the community official responsible for floodplain management, I hereby acknowledge that we have received and reviewed this request for a LOMA. We understand that this request is being forwarded to DHS-FEMA to determine if this property has been inadvertently included in the regulatory floodway. We acknowledge that no fill on this property has been or will be placed within the designated regulatory floodway. We find that the completed or proposed project meets or is designed to meet all of the community floodplain management requirements.

Community Comments:

Community Official's Name and Title: (Please Print or Type)

Telephone No.:

Community Name:

City of Woodland 530035

Community Official's Signature (required):

Date:

