

NOTE: EXTEND SIDEWALK TRANSVERSE EXPANSION JOINTS TO INCLUDE CURB (FULL DEPTH)

CURB FACE DETAIL

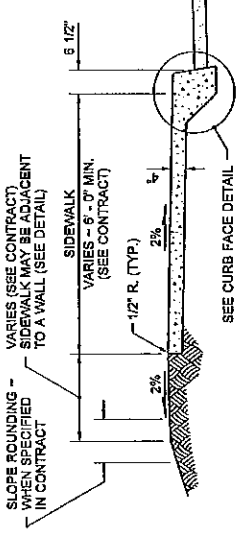

MONOLITHIC CEMENT CONCRETE CURB AND SIDEWALK

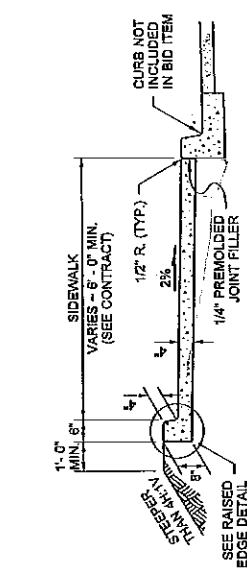

CEMENT CONCRETE SIDEWALK WITH RAISED EDGE

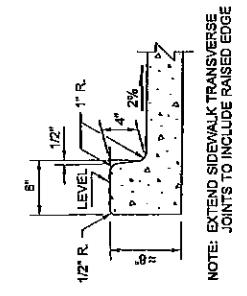

NOTE: EXTEND SIDEWALK TRANSVERSE JOINTS TO INCLUDE RAISED EDGE

RAISED EDGE DETAIL

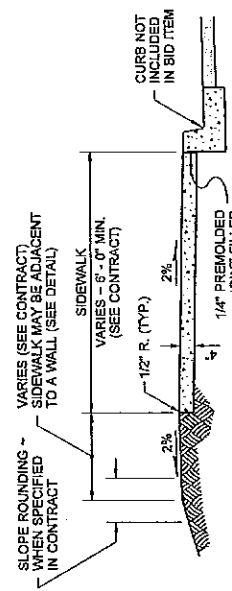

CEMENT CONCRETE SIDEWALK ADJACENT TO CURB

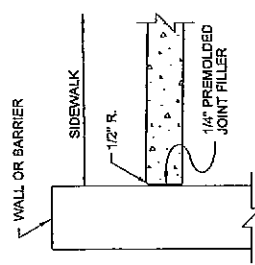

SIDEWALK ADJACENT TO WALL DETAIL

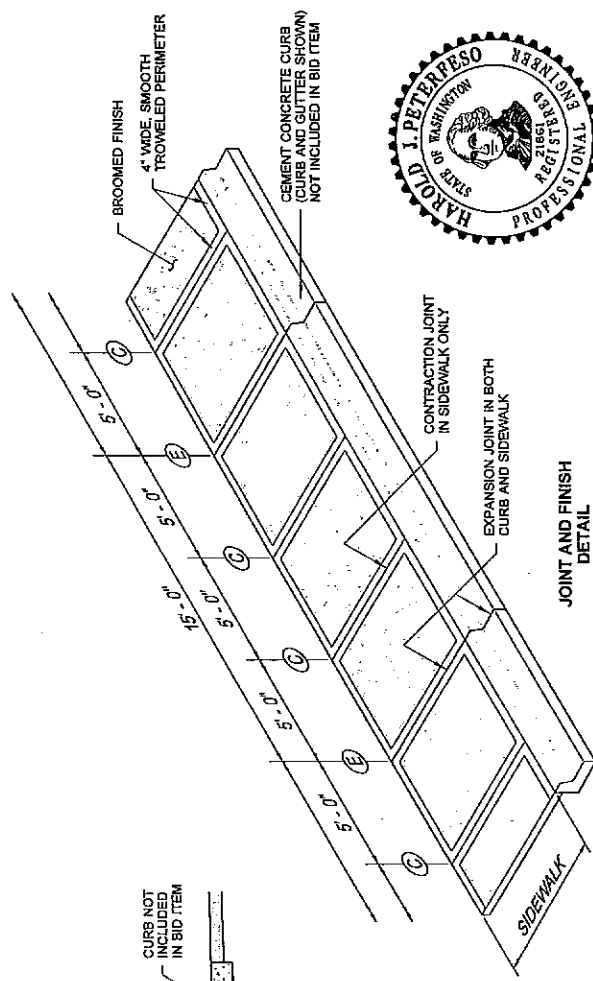

JOINT AND FINISH DETAIL

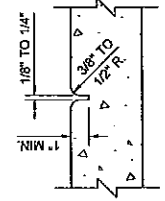

(C) CONTRACTION JOINT

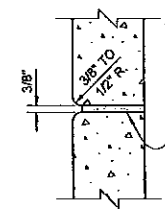

(E) EXPANSION JOINT

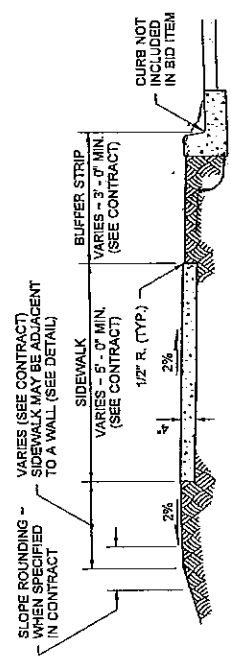

CEMENT CONCRETE SIDEWALK ADJACENT TO BUFFER STRIP



[EXPIRES: MAY 16, 2003]

CEMENT CONCRETE SIDEWALK STANDARD PLAN F-3

SHEET 1 OF 1 SHEET

APPROVED FOR PUBLICATION

Harold J. Peterfeso 01-13-03
 STATE DESIGN ENGINEER DATE
 Washington State Department of Transportation

NOTE: THIS PLAN IS NOT A LEGAL DOCUMENT UNLESS IT IS APPROVED AND SIGNED BY THE ENGINEER OF RECORD. ANY CHANGES TO THIS PLAN MUST BE APPROVED BY THE ENGINEER OF RECORD. A COPY MUST BE OBTAINED UPON REQUEST.

RADIUS (AT CURB FACE)	A	B	C
20 FEET	4' - 5 1/4"	8' - 10 1/2"	3' - 8 1/2"
30 FEET	3' - 10"	7' - 8"	3' - 2 1/4"
40 FEET	3' - 7"	7' - 2"	3' - 0"
50 FEET	3' - 5 1/2"	6' - 10 3/4"	2' - 10 1/2"
60 FEET	3' - 4 1/2"	6' - 8 3/4"	2' - 9 1/2"
70 FEET	3' - 3 3/4"	6' - 7 1/2"	2' - 9"
80 FEET	3' - 3 1/4"	6' - 6 1/2"	2' - 8 1/2"
90 FEET	3' - 2 3/4"	6' - 5 1/2"	2' - 8 1/4"
100 FEET	3' - 2 1/2"	6' - 5"	2' - 8"

INTERMEDIATE RADII CAN BE INTERPOLATED

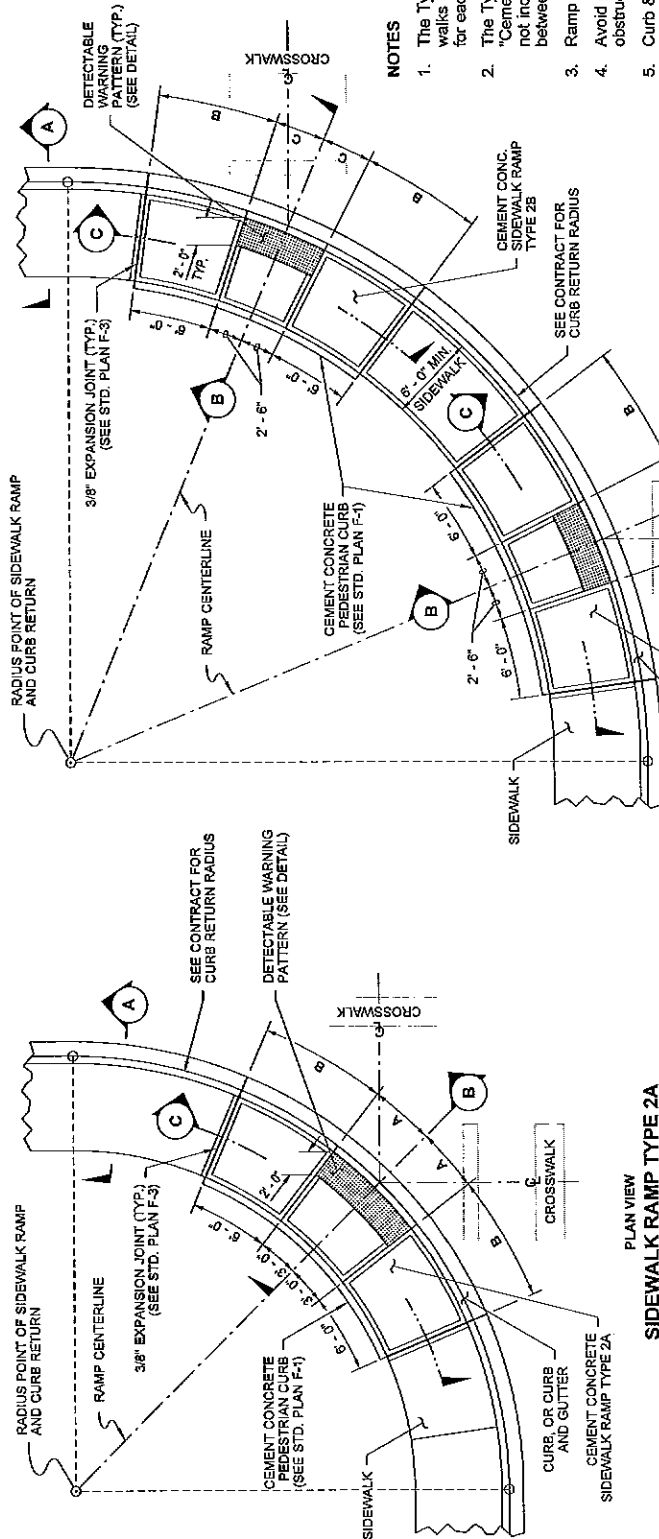

DRAWN BY: MARK SUJKA

NOTES

- The Type 1A Ramp is used to provide access to two crosswalks only when it is infeasible to provide a separate ramp for each crosswalk.
- The Type 2B Ramp Layout requires two (2) of this bid item: "Cement Conc. Sidewalk Ramp Type 2B". The bid item does not include the adjacent Curb (or Curb & Gutter), the Sidewalk between Ramps, or the Cement Conc. Pedestrian Curb.
- Ramp slopes shall not be steeper than 12H:1V.
- Avoid placing drainage structures, junction boxes or other obstructions in front of ramp access areas.
- Curb & Gutter is shown, see the Contract Plans for the curb design specified. See Standard Plan F-1 for curb details.
- See Std. Plan F-3 for sidewalk joint placement and details.
- Detectable warning patterns may be created by any method that will achieve the truncated dome dimensions and spacing shown.

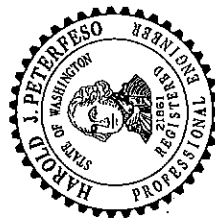

EXPIRES MAY 16, 2005

SIDEWALK RAMP TYPES 2A & 2B WITH LAYOUTS STANDARD PLAN F-3b SHEET 1 OF 1 SHEET

APPROVED FOR PUBLICATION
Harold J. Peterfeso 02-09-05
 STATE DESIGN ENGINEER DATE
 Washington State Department of Transportation

SIDEWALK RAMP TYPE 2A LAYOUT

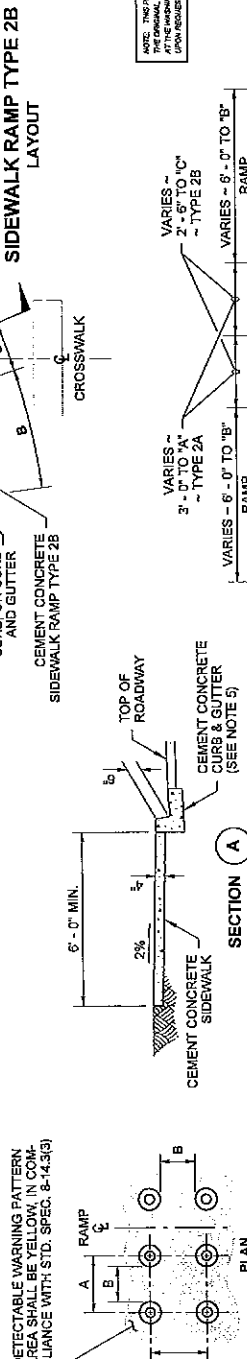

DETECTABLE WARNING PATTERN AREA SHALL BE YELLOW, IN COMPLIANCE WITH STD. SPEC. 8-14.3(3)

MIN.	MAX.
D	1 5/8" 2 3/8"
E	5/8" 1 1/2"
F	7/16" 3/4"
G	7/8" 1 7/16"

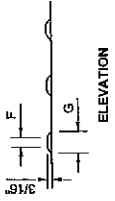

TRUNCATED DOMES (SEE NOTE 7) DETECTABLE WARNING PATTERN DETAIL

SIDEWALK RAMP TYPE 2B LAYOUT

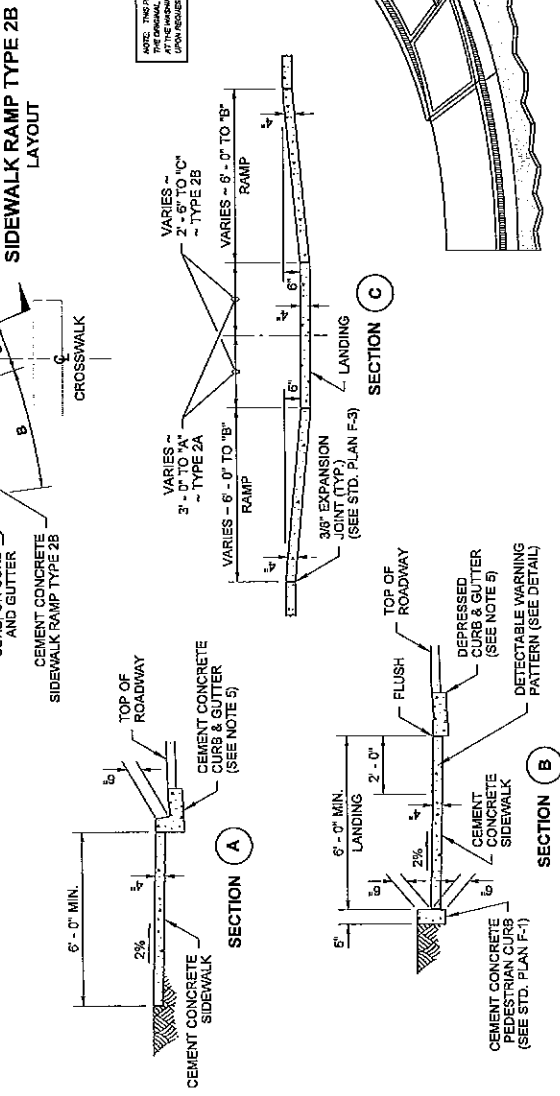

NOTE: THIS PLAN IS NOT A LEGAL ENGINEERING DOCUMENT BUT AN ELECTRONIC DUPLICATE OF THE ORIGINAL DRAWING BY THE ENGINEER AND APPROVED FOR PUBLICATION. IT IS NOT TO BE USED FOR CONSTRUCTION OR FOR ANY OTHER PURPOSE.

ISOMETRIC VIEW

DRAWN BY: MARK SUJKA

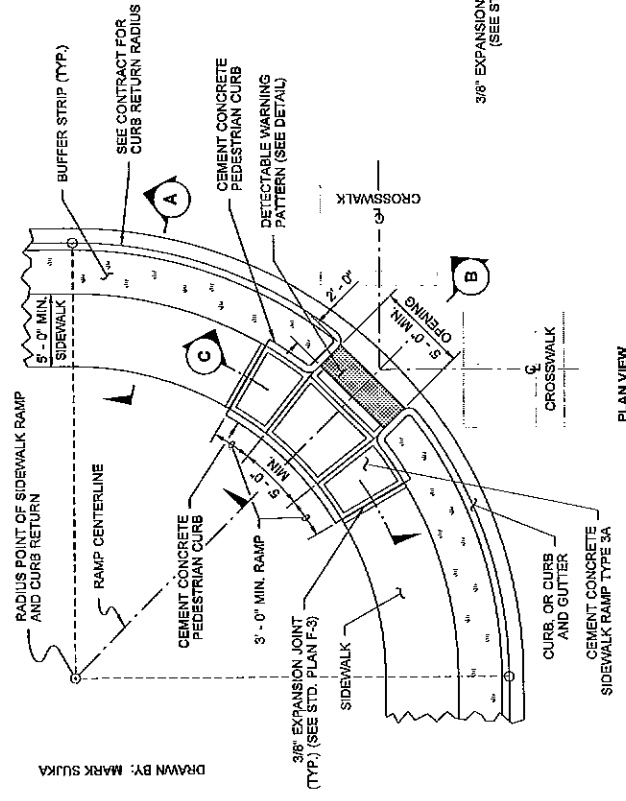

PLAN VIEW
SIDEWALK RAMP TYPE 3A
LAYOUT 1

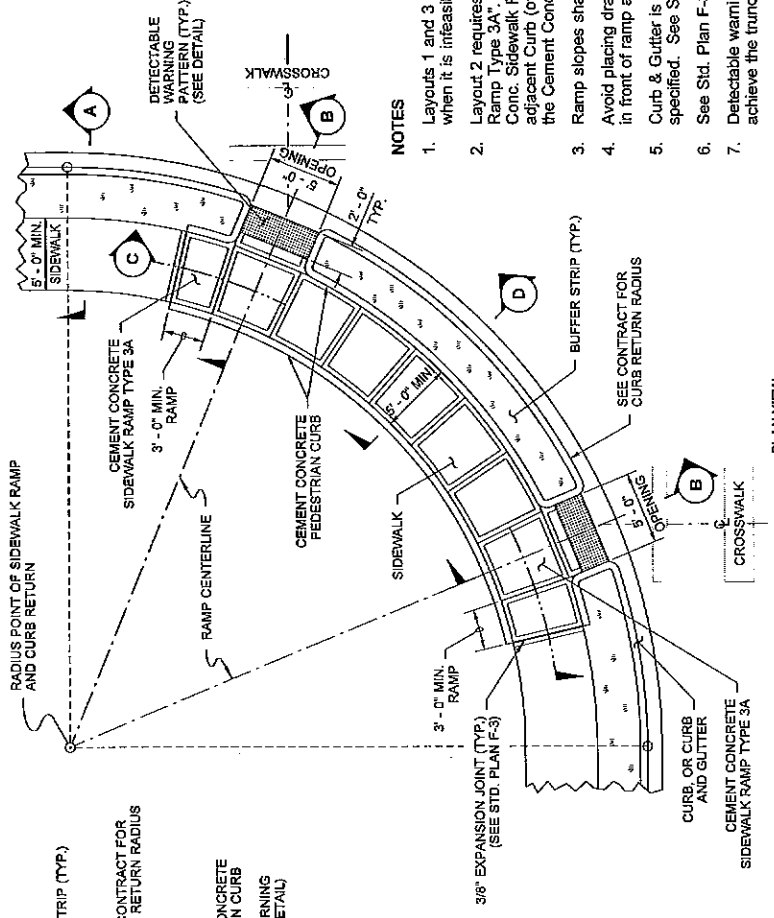

PLAN VIEW
SIDEWALK RAMP TYPE 3A
LAYOUT 2

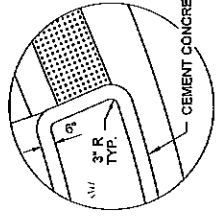

CURB RADIUS DETAIL

NOTE: THIS PLAN IS NOT A LEGAL ENGINEERING DOCUMENT UNLESS IT IS SIGNED AND SEALED BY THE ENGINEER AND APPROVED FOR PUBLICATION AS SET FORTH IN THE WASHINGTON STATE DEPARTMENT OF TRANSPORTATION. A COPY MAY BE OBTAINED FROM THE ENGINEER.

NOTES

- Layouts 1 and 3 are used to provide access to two crosswalks only when it is infeasible to provide a separate ramp for each crosswalk.
- Layout 2 requires two (2) of this bid item: "Cement Conc. Sidewalk Ramp Type 3A". Layout 4 requires two (2) of this bid item: "Cement Conc. Sidewalk Ramp Type 3B". These bid items do not include the adjacent Curb (or Curb & Gutter), the Sidewalk between Ramps, or the Cement Conc. Pedestrian Curb.
- Ramp slopes shall not be steeper than 12H:1V.
- Avoid placing drainage structures, junction boxes or other obstructions in front of ramp access areas.
- Curb & Gutter is shown, see the Contract Plans for the curb design specified. See Standard Plan F-1 for curb details.
- See Std. Plan F-3 for sidewalk joint placement and details.
- Detectable warning patterns may be created by any method that will achieve the truncated dome dimensions and spacing shown.

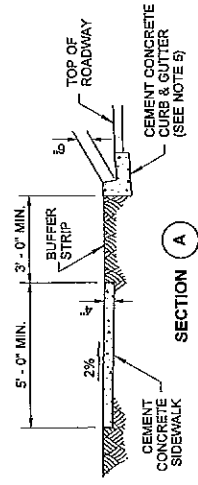

SECTION A

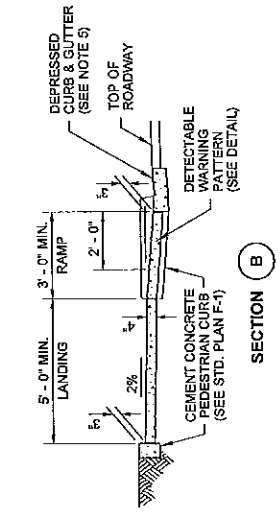

SECTION B

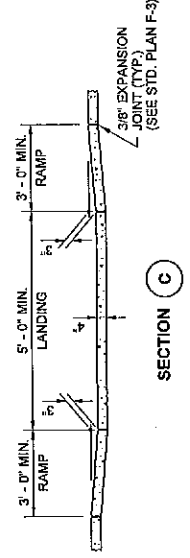

SECTION C

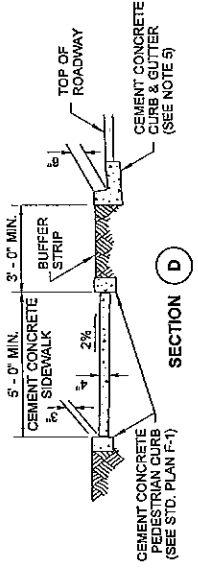

SECTION D

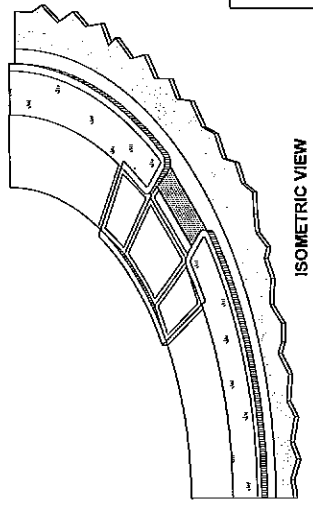

ISOMETRIC VIEW



EXPIRES MAY 16, 2005

**SIDEWALK RAMP
TYPES 3A & 3B
WITH LAYOUTS
STANDARD PLAN F-3c**

SHEET 1 OF 2 SHEETS

APPROVED FOR PUBLICATION

Harold J. Peterfeso
STATE ENGINEER
Washington State Department of Transportation

02-09-05 DATE

DETECTABLE WARNING PATTERN AREA SHALL BE YELLOW, IN COMPLIANCE WITH STD. SPEC. 8-14.3(3)

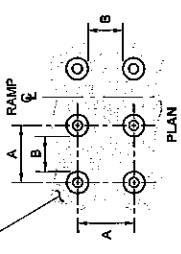

	MIN.	MAX.
A	1 5/8"	2 3/8"
B	5/8"	1 1/2"
C	7/16"	3/4"
D	7/8"	1 7/16"

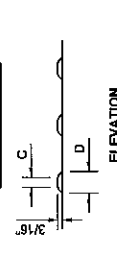

TRUNCATED DOMES (SEE NOTE 7)
DETECTABLE WARNING PATTERN DETAIL



EXPIRES MAY 16, 2005

SIDEWALK RAMP TYPES 3A & 3B WITH LAYOUTS STANDARD PLAN F-3c

SHEET 2 OF 2 SHEETS

APPROVED FOR PUBLICATION

Harold J. Peterfeso
STATE DESIGN ENGINEER
Washington State Department of Transportation

02-09-05
DATE

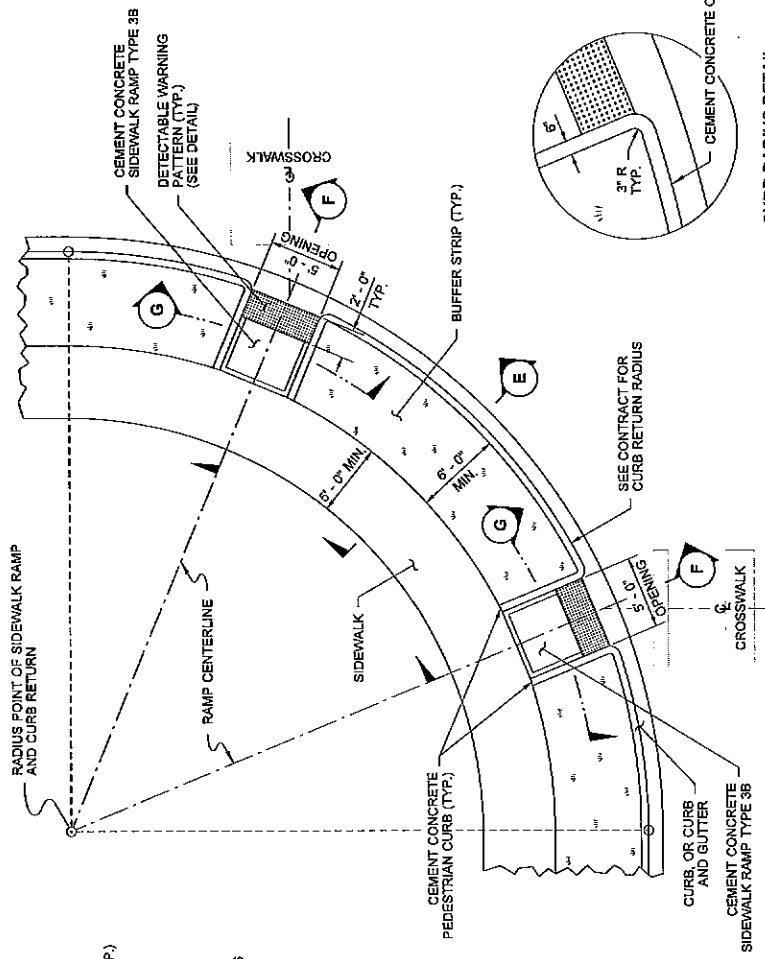

PLAN VIEW
SIDEWALK RAMP TYPE 3B
LAYOUT 4

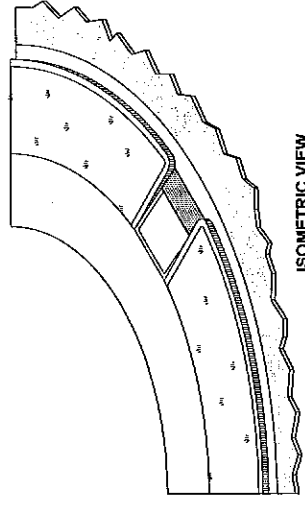

ISOMETRIC VIEW

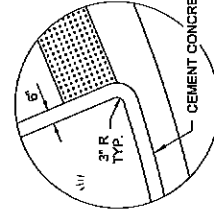

CURB RADIUS DETAIL

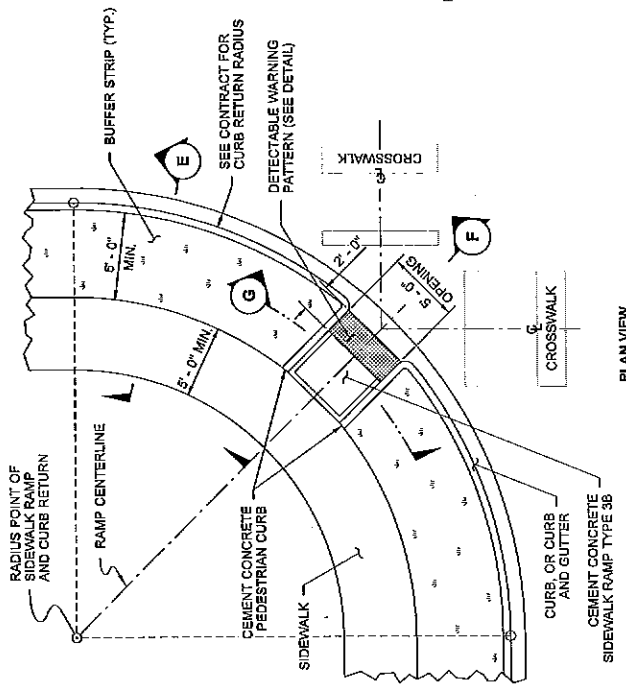

PLAN VIEW
SIDEWALK RAMP TYPE 3B
LAYOUT 3

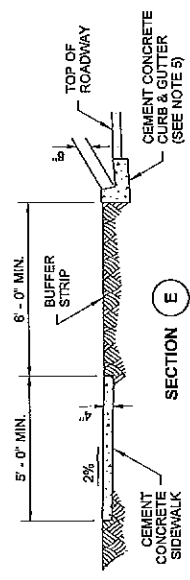

SECTION E

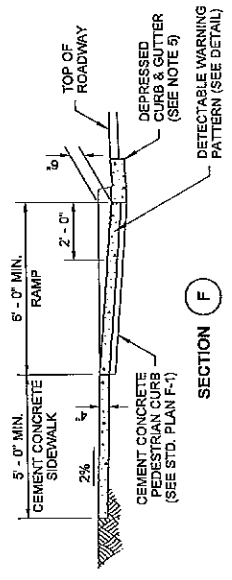

SECTION F

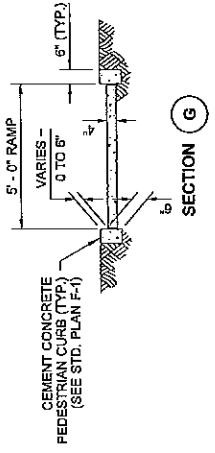

SECTION G

NOTE: THIS PLAN IS ONLY A LOCAL GOVERNING DOCUMENT. ALL ELECTRONIC DOCUMENTS ARE THE ORIGINAL, SIGNED BY THE ENGINEER AND APPROVED FOR PUBLICATION, IS LEFT OF FILE AT THE INFORMATION STATE DEPARTMENT OF TRANSPORTATION. A COPY MAY BE OBTAINED UPON REQUEST.

RADIUS (AT CURB FACE)	X	Y
20 FEET	5' - 1 3/4"	2' - 7 1/4"
30 FEET	7' - 11 3/4"	4' - 8 1/4"
40 FEET	9' - 5 1/4"	6' - 5"
50 FEET	10' - 8 3/4"	7' - 11 1/4"
60 FEET	11' - 10 1/4"	9' - 3 1/2"
70 FEET	12' - 10 3/4"	10' - 6 3/4"
80 FEET	13' - 10 1/2"	11' - 8 3/4"
90 FEET	14' - 9 1/4"	12' - 9 3/4"
100 FEET	15' - 7 1/2"	13' - 10 1/4"

INTERMEDIATE RADII CAN BE INTERPOLATED

- NOTES**
- This layout is used to provide access to a single crosswalk parallel to the major street. The bid item "Cement Conc. Sidewalk Ramp Type 4A" does not include the adjacent Curb (or Curb & Gutter), the Sidewalk, or the Cement Conc. Pedestrian Curb.
 - Ramp slopes shall not be steeper than 12H:1V.
 - Avoid placing drainage structures, junction boxes or other obstructions in front of ramp access areas.
 - Curb & Gutter is shown, see the Contract Plans for the curb design specified. See Standard Plan F-1 for curb details.
 - See Std. Plan F-3 for sidewalk joint placement and details.
 - Detectable warning patterns may be created by any method that will achieve the truncated dome dimensions and spacing shown.

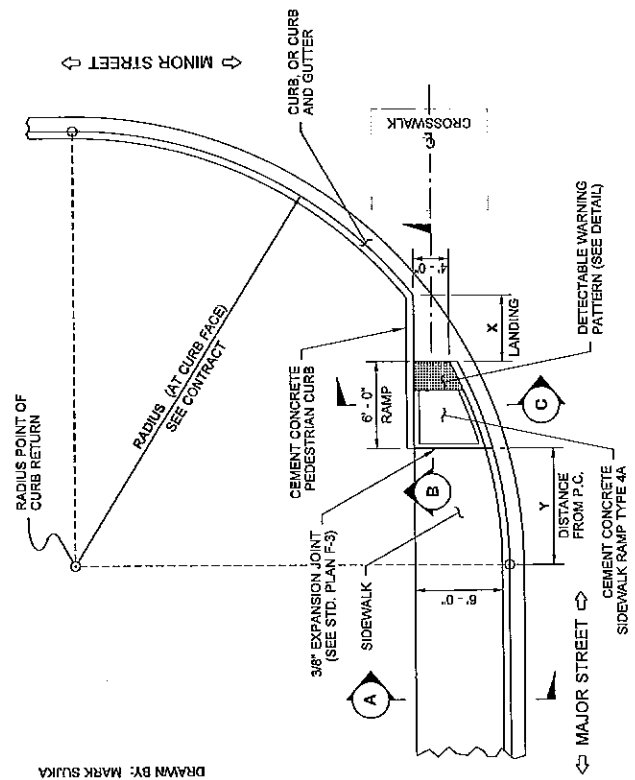

SIDEWALK RAMP TYPE 4A LAYOUT

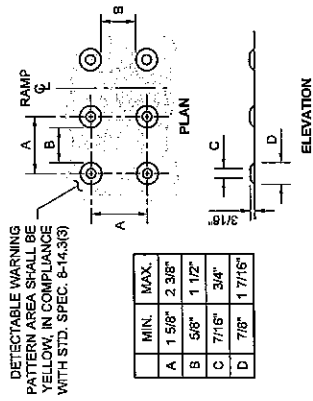
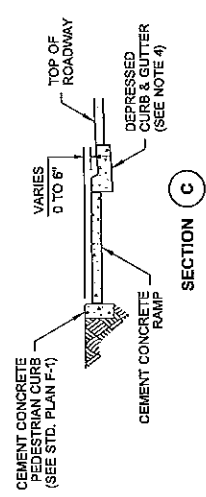
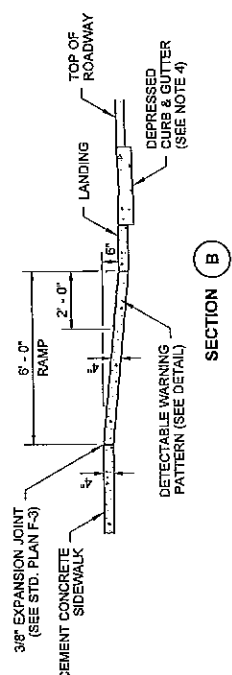
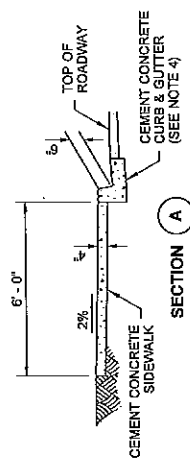

	MIN.	MAX.
A	1 5/8"	2 3/8"
B	5/8"	1 1/2"
C	7/16"	3/4"
D	7/8"	1 7/16"

DETECTABLE WARNING PATTERN AREA SHALL BE YELLOW IN COMPLIANCE WITH STD. SPEC. 6-14.3(3)



EXPIRES MAY 16, 2005

SIDEWALK RAMP TYPE 4A WITH LAYOUT

STANDARD PLAN F-3d

SHEET 1 OF 1 SHEET

APPROVED FOR PUBLICATION

Harold J. Peterfesso 02-09-05 DATE

STATE DESIGN ENGINEER Washington State Department of Transportation

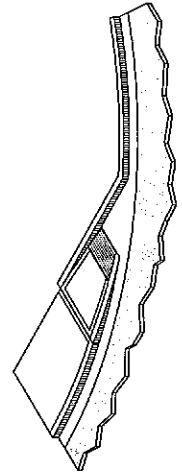

NOTES: THIS PLAN IS NOT A LEGAL ENGINEERING DOCUMENT UNLESS IT IS ACCOMPANIED BY AN ELECTRONIC SIGNATURE AND A STATE-APPROVED CERTIFICATE OF AUTHORITY. ANY CHANGES TO THIS PLAN SHALL BE MADE BY THE STATE DEPARTMENT OF TRANSPORTATION. A COPY MAY BE OBTAINED UPON REQUEST.

RADIUS (AT CURB FACE)	W = 3'-0"		W = 4'-0"		W = 5'-0"		W = 6'-0"		W = 7'-0"	
	X	Y	X	Y	X	Y	X	Y	X	Y
20 FEET	5'-5 1/2"	4'-6 1/2"	4'-8 1/2"	5'-0"	4'-1"	7'-2 3/4"	3'-7"	8'-3 1/2"	3'-1 1/2"	9'-2 1/2"
30 FEET	7'-3 3/4"	7'-1"	6'-5 1/2"	8'-11 1/2"	5'-9 1/4"	10'-7"	5'-2 1/2"	12'-0"	4'-8 3/4"	13'-3 1/4"
40 FEET	8'-9 1/2"	9'-2 1/2"	7'-10"	11'-5 1/4"	7'-1"	13'-4 1/2"	6'-5 3/4"	15'-3 3/4"	5'-11 1/2"	16'-7 1/4"
50 FEET	10'-3/4"	11'-3/4"	9'-1 1/4"	13'-7 1/4"	8'-2 1/2"	15'-9 1/2"	7'-8 1/2"	17'-9"	6'-11 3/4"	19'-6 1/4"
60 FEET	11'-2 1/2"	12'-8 3/4"	10'-3/4"	15'-6 1/2"	9'-2 1/4"	17'-11 3/4"	8'-5 3/4"	20'-1 3/4"	7'-10 1/2"	22'-1 1/2"
70 FEET	12'-2 3/4"	14'-3 1/4"	11'-1/4"	17'-4"	10'-1"	19'-11 3/4"	9'-3 3/4"	22'-4 1/4"	8'-8 1/4"	24'-6 1/4"
80 FEET	13'-2"	15'-8 1/2"	11'-10 1/2"	18'-11 3/4"	10'-10 3/4"	21'-10"	10'-1"	24'-4 3/4"	9'-5"	26'-8 3/4"
90 FEET	14'-12"	17'-12"	12'-8 1/4"	20'-6 1/2"	11'-7 3/4"	23'-7"	10'-9 3/4"	26'-3 3/4"	10'-1 1/4"	28'-9 1/2"
100 FEET	14'-10 1/2"	18'-3 3/4"	13'-5 1/2"	22'-0"	12'-4 1/4"	25'-2 3/4"	11'-5 3/4"	28'-1 1/2"	10'-9"	30'-9"

INTERMEDIATE RADII CAN BE INTERPOLATED

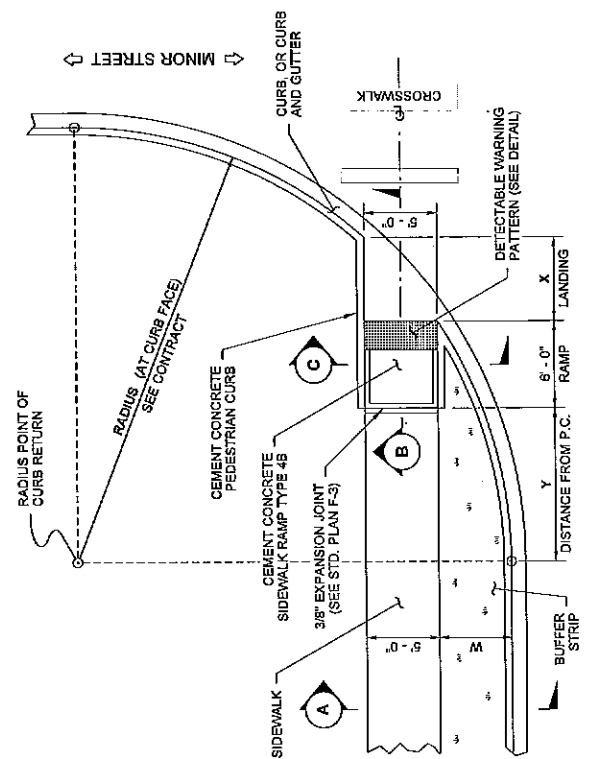

PLAN VIEW
SIDEWALK RAMP TYPE 4B
PLAN

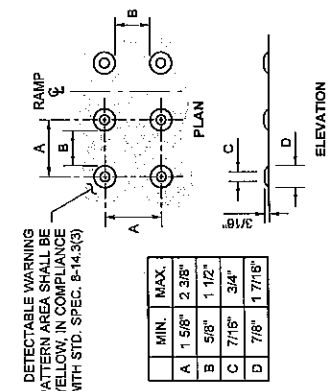

	MIN.	MAX.
A	1 5/8"	2 3/8"
B	5/8"	1 1/2"
C	7/16"	3/4"
D	7/8"	1 7/16"

TRUNCATED DOMES (SEE NOTE 6)
DETECTABLE WARNING
PATTERN DETAIL

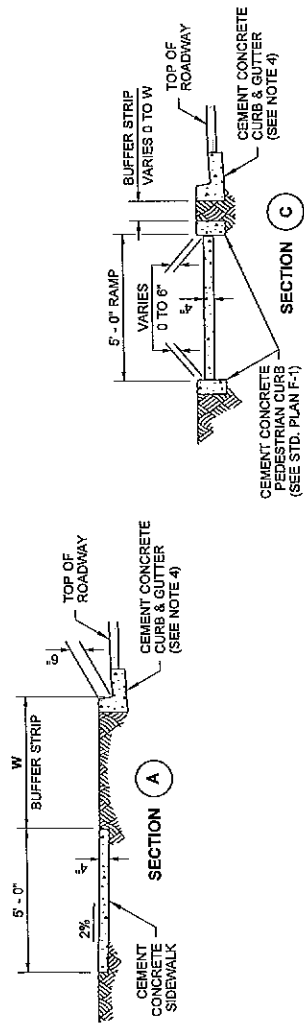

SECTION A
SECTION C

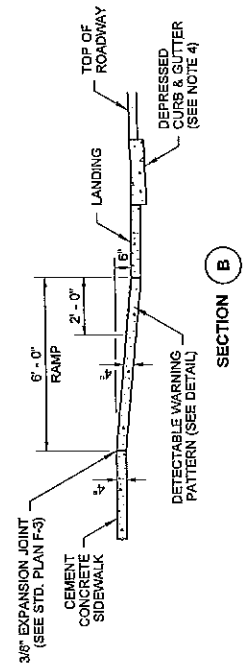

SECTION B

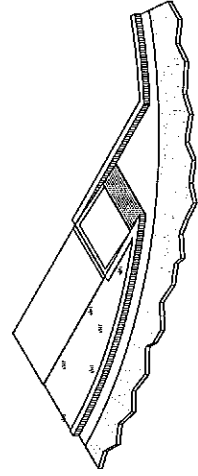

ISOMETRIC VIEW

NOTES

1. This layout is used to provide access to a single crosswalk parallel to the major street. The bid item "Cement Conc. Sidewalk Ramp Type 4B" does not include the adjacent Curb (or Curb & Gutter), the Sidewalk, or the Cement Conc. Pedestrian Curb.
2. Ramp slopes shall not be steeper than 12H:1V.
3. Avoid placing drainage structures, junction boxes or other obstructions in front of ramp access areas.
4. Curb & Gutter is shown, see the Contract Plans for the curb design specified. See Standard Plan F-1 for curb details.
5. See Std. Plan F-3 for sidewalk joint placement and details.
6. Detectable warning patterns may be created by any method that will achieve the truncated dome dimensions and spacing shown.



EXPIRES MAY 16, 2005

SIDEWALK RAMP TYPE 4B
WITH LAYOUT
STANDARD PLAN F-3e
SHEET 1 OF 1 SHEET

APPROVED FOR PUBLICATION
Harold J. Peterfeso
STATE DESIGN ENGINEER
02-09-05
DATE
Washington State Department of Transportation

NOTE: THIS PLAN IS NOT A LEGAL ENGINEERING DOCUMENT NOR AN ELECTRONIC DUPLICATE. THE ORIGINAL, SIGNED BY THE ENGINEER AND APPROVED FOR PUBLICATION, IS REQUIRED FOR CONSTRUCTION. ANY CHANGES TO THE ORIGINAL SHALL BE MADE BY THE ENGINEER AND APPROVED FOR PUBLICATION. A COPY MUST BE KEPT ON FILE AT ALL TIMES.